

2024 SDHSAA State Wrestling Championships

DUAL CHAMPIONSHIP SPECIFIC INFO

Class A – Brookings Dacotah Bank Center

February 10, 2024

DUAL-TOURNEY SPECIFIC INFO

FORMAT & SCHEDULE:

Eight teams will qualify for the quarterfinal round of team dual competition. Four teams will qualify for the semifinals and consolations semifinals. A State Championship, Third Place and Fifth Place match will be held for each classification, with awards being presented to all six teams who advance to those matches.

Tournament schedule is as follows (brackets can be found at the end of the document):

- Quarterfinals – Saturday, February 10, - 11:00 AM CST
- Semifinals – Saturday, February 10, - 15 minutes after Quarterfinals
- Championship & 3rd Place, 5th place Matches – Semifinals – Saturday, February 25, - 2:00pm

All Class “A” Matches will be held on Mats 1,2,3,4

ROSTER:

ONLY CREDENTIALLED COACHES AND ATHLETES WILL BE ALLOWED ON THE FLOOR. Violations of either will result in team point deductions OR forfeiture of the dual.

Each team will be sent an invite through TrackWrestling to upload its roster for the Dual Championships.

ROSTER LIMITATION – No more than 19 total wrestlers (14+5) may be entered. Only 19 competitors will be allowed on the team bench area/as participants in the dual. These 19 are specific and cannot be changed except for illness or injury that is verified with documentation by SDHSAA staff.

Rosters for Programs are due by Monday February 5 at Noon.

DEADLINE for Roster Entry will be 12 PM CT, Wednesday (February 7) prior to the event.

TEAM ENTRANCE and BUS PARKING:

Please enter the facility using the Northeast Lobby entrance which is located on the Northeast corner of the building. The entrance will be marked with a **team drop off sign**. Participants/coaches can exit the bus and the busses will park in the parking lot across from the entrance. **Please DO NOT enter through the public main entrances.**

WRESTLER ELIGIBILITY & WEIGH-INS:

All wrestlers are eligible to compete in the Dual Championships that are otherwise eligible for a team and are listed on the entry through TrackWrestling.

All wrestlers who *may* participate in duals on Saturday *also* weigh in at the prescribed times (8:30 AM Saturday). Doors will open at 7:30am, 1 hour before official weigh-ins begin. Wrestlers must weigh in & make weight at the weight class for which they would be eligible based on **certification and their descent plan**

Following Weigh-Ins, SDHSAA Executive Staff will generate a combined weigh-in sheet for all competing teams in the DUAL championship event, which will be available for review at Tournament Headquarters/Head Table, as well as distribute a sheet to each Head Coach for their own team as well as that day's opponent(s). **Weigh-In Procedures will be sent out to individual schools.**

PRACTICE

The facility will be available for practice on Friday for two sessions. 6:00pm-7:00pm (4 Teams) and 7:00pm-8:00pm (4 Teams). Team Practices will be decided by distance with the furthest 4 teams practicing at the later times. More information will be sent to schools individually.

TEAM PACKET PICKUP

Team packet pickup will be on Friday from 6:00pm-8:00pm or Saturday morning.

COMPETITION RULES:

Rules of competition of a DUAL event will follow those of the NFHS Rulebook and SDHSAA Handbook as published for any other dual event, including NFHS Rules 6 and 11 on reporting, starting and conduct of a dual match and team-advancement tournament. All duals will begin at the same time, but will progress independently of the others occurring simultaneously (we will not wait for all 106# matches to continue to 113; rather the schedule of each individual dual will "roll").

Mat Assignments will be determined by seeds participating and shared on-site with coaches prior to the competition. Each team will have a bench area and specific corner in which team personnel must remain at all times during competition. Officials will work in two-man pairs for all duals, with a designated head and assistant referee that will remain in those positions for the duration of a single dual.

The RANDOM DRAW has been conducted in presence of a notary at the SDHSAA. This will be announced at the day of the tournament.

Weights for the start of each round of duals are as follows:

Quarterfinal: **175** pounds

Semifinal: **190** pounds

Championship/3rd Place/4th Place/6th Place: **215** pounds

ADDITIONAL RULINGS:

Should any additional rulings be needed in regard to the conduct of the matches, the SDHSAA Executive Staff on site as well as Tournament Officials are to be considered the final authority as provided by NFHS and SDHSAA Rule to rule on situations not covered explicitly by rule, handbook, or coaches' documentation.

State DUAL Tournament

A. Format & Qualifying Procedures

1. **On an annual basis, all teams will be considered for participation in the Dual Championships. There is no longer an opportunity to "opt out" of the event other than by way of competing in less than the required number of duals.**
 - a. Teams will need to have the entirety of their DUAL schedule posted to the SDHSAA.com website by no later than December 1st. No further events can be added to the schedule after that date, and only SDHSAA-office approved changes may be made to the schedule without a win/loss/forfeit being awarded. **Last Day for Team Duals for Seeding is Saturday February 3, 2024**
 - b. Teams must compete in a minimum of eight regular-season varsity duals to be considered as eligible for the SDHSAA State Dual Championships.
2. To determine the eight qualifying dual teams for each classification, the SDHSAA Seed Point Formula will be utilized for all regular season duals.
 - a. All SDHSAA teams will report all regular season DUAL results against teams from either South Dakota or a state contiguous to South Dakota to the SDHSAA website to establish accurate team records. Result reporting will simply be an indication of "Win" or "Loss" of any/all direct team dual competition, both those that are singularly scheduled, as well as those as part of a team-bracket tournament.
 - b. Seed points will be awarded according to the following criteria based upon records of schools involved in dual competition: Seed points will be awarded based upon opponent's win percentage as shown in the chart below.

*Win percentage = number of varsity dual wins divided by the number of varsity dual matches contested.

Opponent's DUAL Winning Percentage	Points for Win	Points for Loss
.750 and above	50	39
.500 - .749	47	36
.250 - .499	44	33
.249 and below	41	30

1. No points are deducted for wrestling teams which are classified below your classification.
 2. No additional points are awarded for wrestling teams which are classified above your classification.
 3. No duals against non-varsity opponents will count toward seed points
 4. A team's seed point average will be determined by dividing the total number of seed points earned by the total number of duals wrestled against varsity opponents, regardless of the opponent's classification.
3. **Updated, 2020:** To determine the eight teams in the State Dual, the top ten teams by seed point will be evaluated for qualification. Evaluation will be done by criteria in order, much as individuals are determined. Qualifications will be, in order: Head-to-Head, Common Opponents, Power Point Average, Last year's place @ State Duals, Last year's place @ State Individual, Coin Flip.
 4. Should a tie exist for the tenth qualifying spots for a top-eight seeding, the following criteria shall be applied to break the tie (if multiple teams are tied, items a through e shall be used in consecutive order to break the tie either positively or negatively, and the remaining teams will then be re-evaluated beginning with "a"):
 - a. If teams have identical point averages and are tied for one of the qualifying seeds, direct head-to-head competition in duals would be used to separate the tie. If teams have met multiple times, the higher winning percentage will determine the head-to-head winner.
 - b. Total Opponent's Dual Winning Percentages (All opponents team dual wins divided by all opponents team dual matches)
 - c. Team with the lowest average number of forfeits per dual (The team with the fewest forfeits on average in regular season duals shall get the seed)
 - d. Team with the highest average team points in all regular season varsity duals
 - e. Coin flip
 5. In order to qualify for, medal and place at the State Dual Team Championships, teams must be able to fill:
 - a. Ten of the fourteen weight classes in Class A in all State Championship Dual Matches
 - b. Eight of the fourteen weight classes in Class B in all State Championship Dual Matches
 6. Eight teams will qualify for the quarterfinal round of team dual competition. Four teams will qualify for the semifinals and consolations semifinals. A State Championship, Third Place and Fifth Place match will be held for each classification, with awards being presented to all four teams who advance to those matches.

State Wrestling Dual Team Tournament Time Schedule – Updated for 2023-24

SATURDAY FEBRUARY 10, 2024

SATURDAY - FIRST SESSION - SEPARATE SITES			
8:30 AM	Weigh-Ins		
11:00 AM	Quarterfinal Duals	Team	Mats 1, 2, 3, 4,
15 min after	Semifinal Duals	Team	Mats 1, 2, 3, 4,
2:00 PM	Championship/3rd Place /5th Place Duals	Team	Mats 1, 2, 3,

BRACKETS:

See Next Two Pages for SDHSAA DUAL Brackets. Updated Brackets will be on the SDHSAA Website once teams are set.

<https://www.sdhsaa.com/activity/wrestling-championships/>

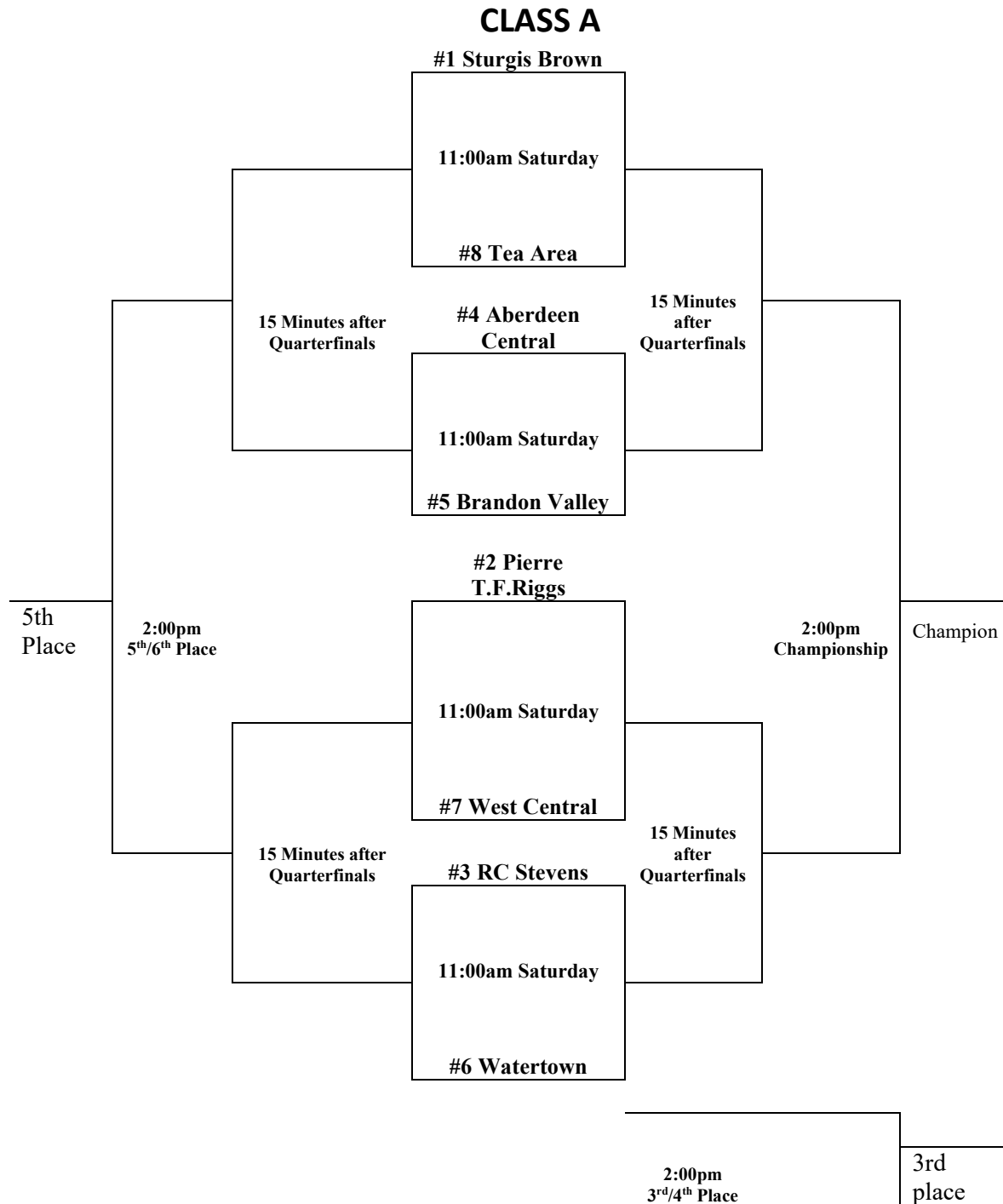

SDHSAA State Class A Wrestling Dual Tournament

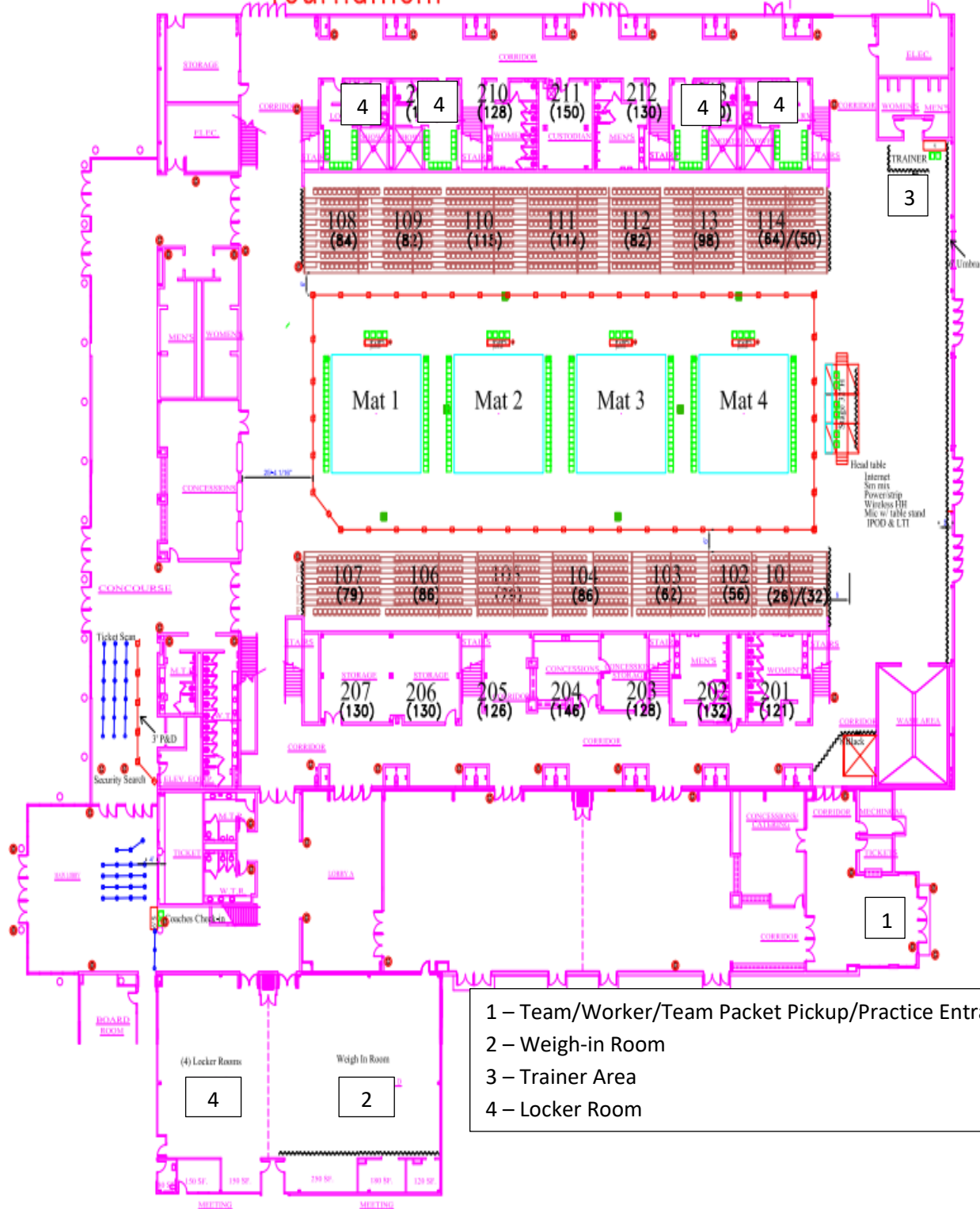

- 1 – Team/Worker/Team Packet Pickup/Practice Entrance
- 2 – Weigh-in Room
- 3 – Trainer Area
- 4 – Locker Room